

**FPZ**  
BLOWER TECHNOLOGY

# 10DL/15DH SERIES-MD MOR

EU VERSION

## TECHNICAL CHARACTERISTICS

- Aluminium alloy construction
- High efficiency impeller

## OPTIONS

- Special Voltages (IEC 60038)
- Surface treatments
- Increased seal version

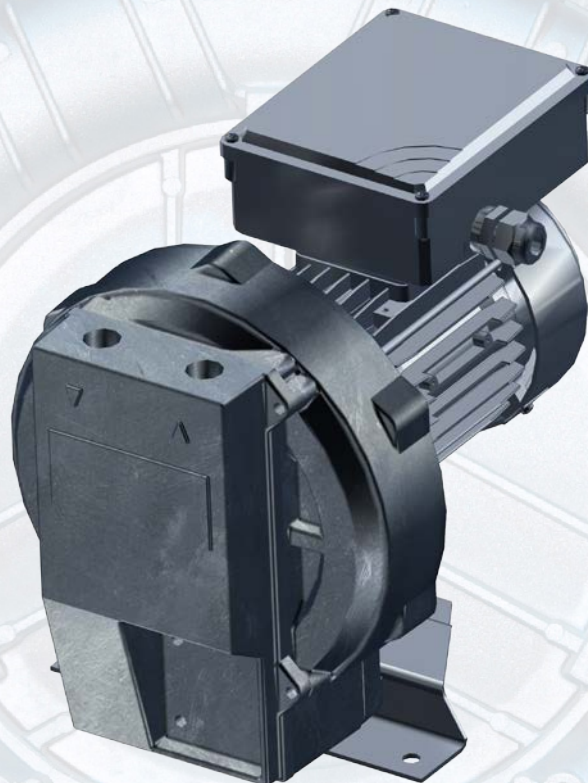

COMPANY WITH QUALITY MANAGEMENT  
SYSTEM CERTIFIED BY DNV  
= ISO 9001:2008 =



Data sheet

LATERAL CHANNEL BLOWERS-EXHAUSTERS

## PRESSURE

Model	N 2900 rpm [kW]	N 3500 rpm [kW]	Q max 2900 rpm [m³/h]	Q max 3500 rpm [m³/h]	ΔP max 2900 rpm [hPa] (mbar)	ΔP max 3500 rpm [hPa] (mbar)	Leq <sup>1</sup> 2900 rpm (Lp) [dB(A)]	Leq <sup>1</sup> 3500 rpm (Lp) [dB(A)]	Weight <sup>2</sup> max [kg]
10DL-MD	<b>0,37</b>	0,43	30	35	200	175	62	64	10
15DH-MD	<b>0,55</b>	0,63	50	58	300	275	62	64	12,5

## VACUUM

Model	N 2900 rpm [kW]	N 3500 rpm [kW]	Q max 2900 rpm [m³/h]	Q max 3500 rpm [m³/h]	ΔP max 2900 rpm [hPa] (mbar)	ΔP max 3500 rpm [hPa] (mbar)	Leq <sup>1</sup> 2900 rpm (Lp) [dB(A)]	Leq <sup>1</sup> 3500 rpm (Lp) [dB(A)]	Weight <sup>2</sup> max [kg]
10DL-MD	<b>0,37</b>	0,43	30	35	150	175	62	64	10
15DH-MD	<b>0,55</b>	0,63	50	58	275	275	62	64	12,5

## INSTALLATION

- For proper use, the blower should be equipped with INLET FILTER and Flow Relief VALVE; other accessories available on request.
- Ambient temperature from -15° to +40°C (+5° to +104° F).
- Specifications subject to change without notice.
- Before installation read carefully all instructions.

<sup>1</sup> Noise measured at 1 m distance with inlet and outlet ports piped, in accordance to ISO 3744.

<sup>2</sup> Value refers to the weight of the machine with 3 Phase motor if MOR range, without motor if GOR or GVR range.

N: Installed motor power

Q: Flow rate

ΔP: Differential pressure

Leq: Noise Level

## PRESSURE

### 2900 rpm (50 Hz)

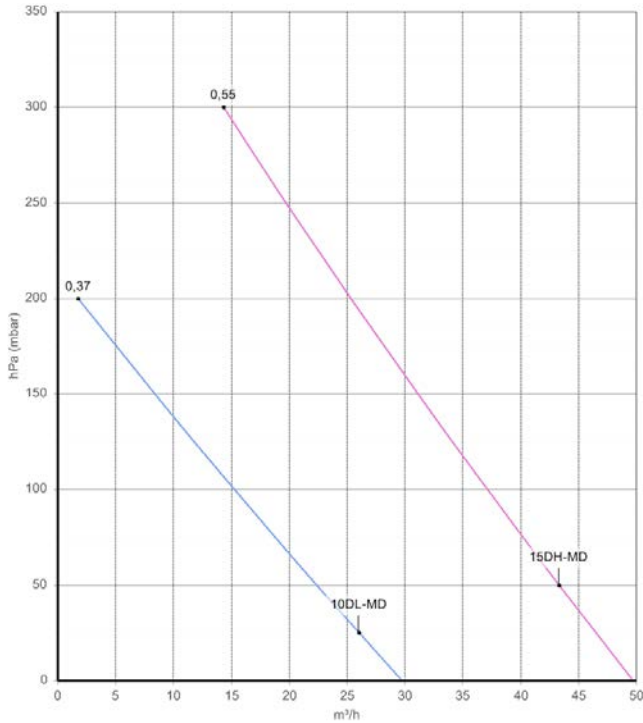

### 3500 rpm (60 Hz)

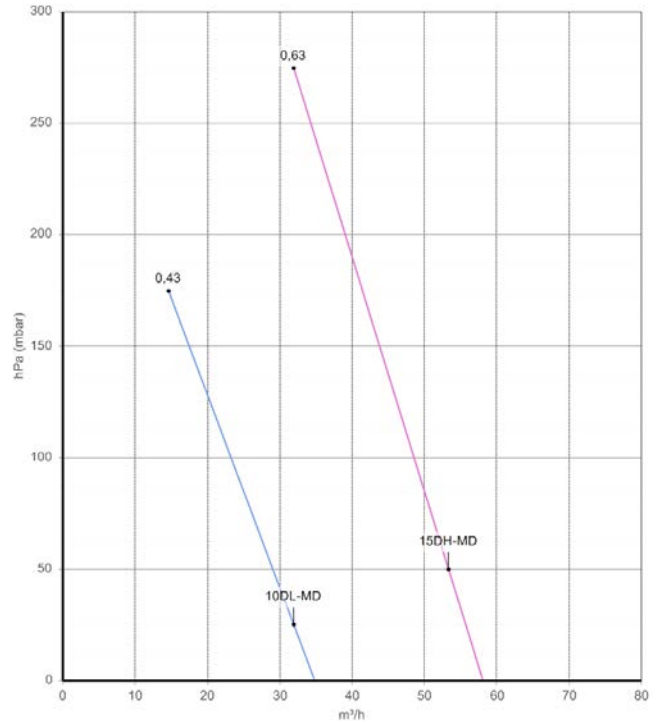

FLOW RATE

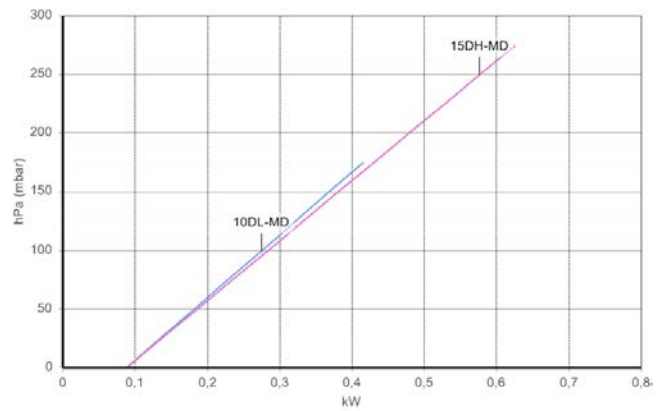
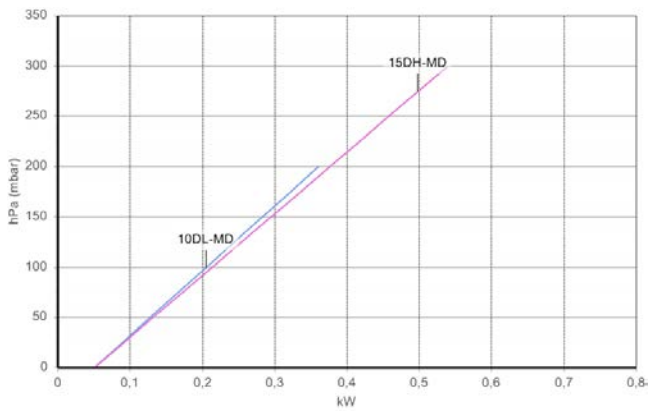

ABSORBED POWER

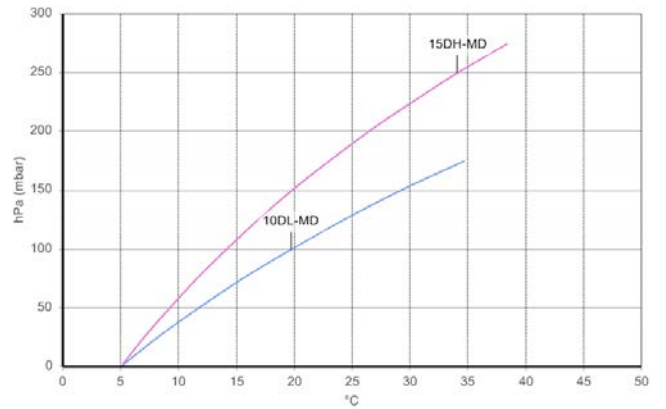
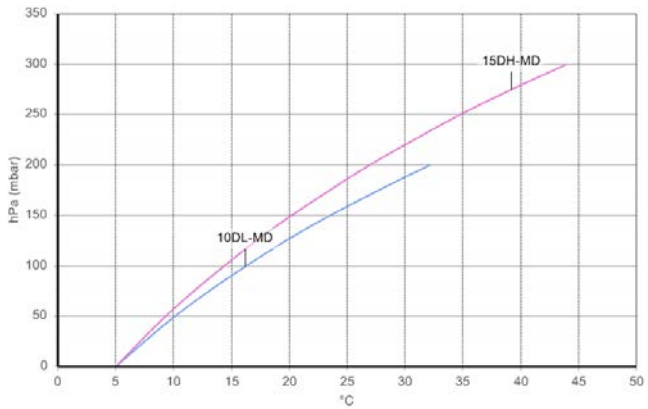

TEMPERATURE INCREASE

Curves refer to air at 20°C (68° F) temperature and 1013 mbar (29.92 In Hg) atmospheric pressure (abs) measured at inlet port.  
Values for flow, power consumption and temperature rise: ±10% tolerance.  
Data can change without prior notice.

VACUUM

2900 rpm (50 Hz)

3500 rpm (60 Hz)

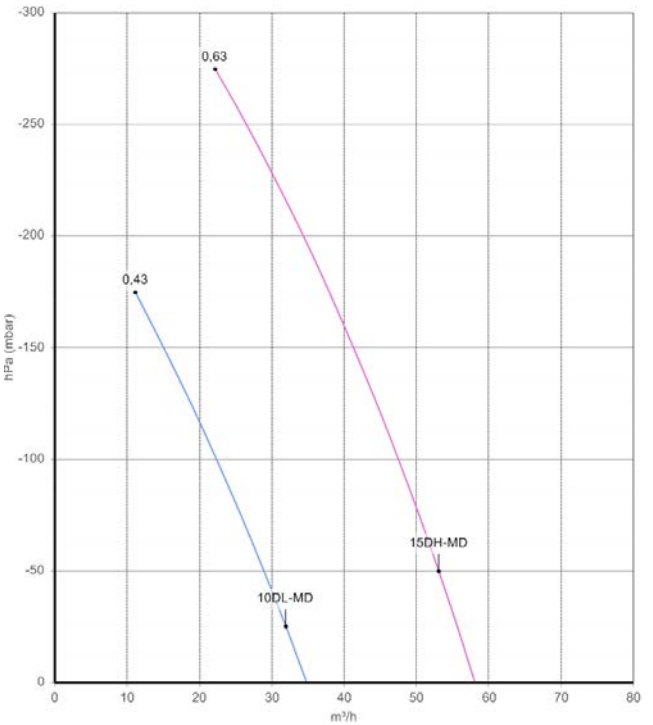
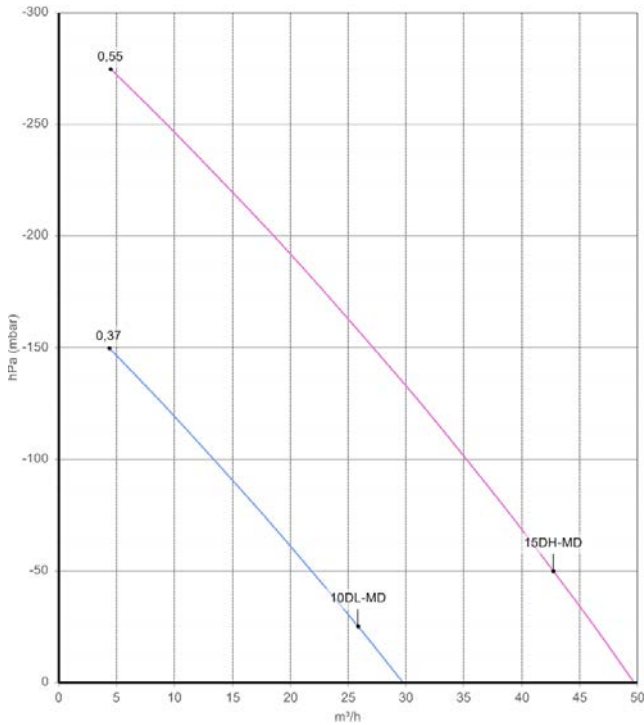

FLOW RATE

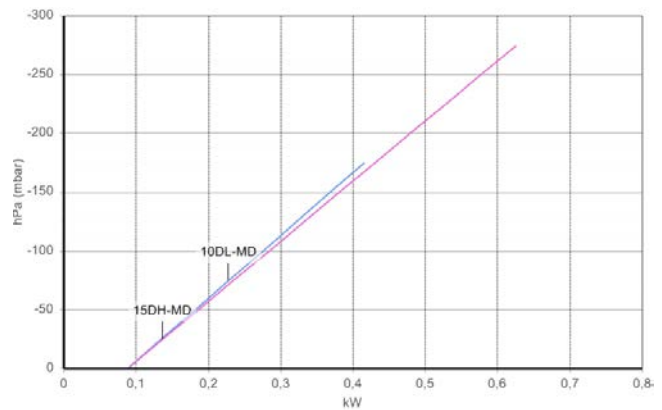
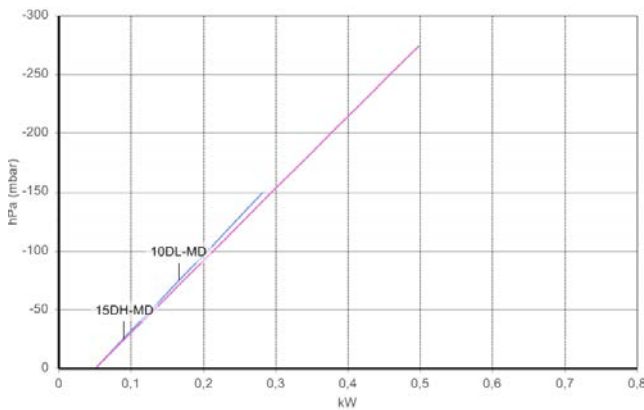

ABSORBED POWER

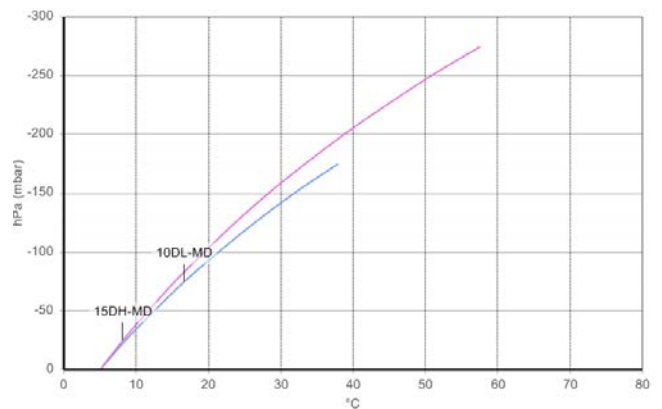
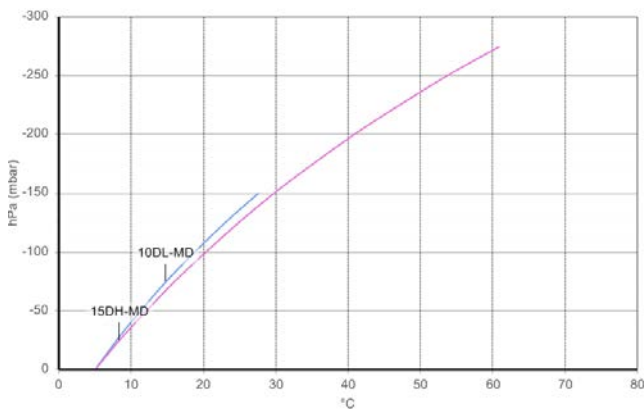

TEMPERATURE INCREASE

Curves refer to air at 20°C (68°F) temperature, measured at inlet port and 1013 mbar (29.92 In Hg) atmospheric backpressure (abs).  
 Values for flow, power consumption and temperature rise: ± 10% tolerance.  
 Data can change without prior notice.

**DIMENSIONS (10DL-MD/15DH-MD)**

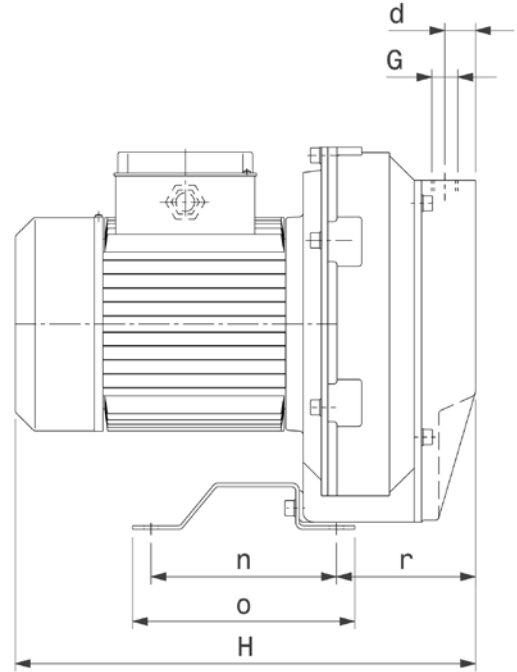
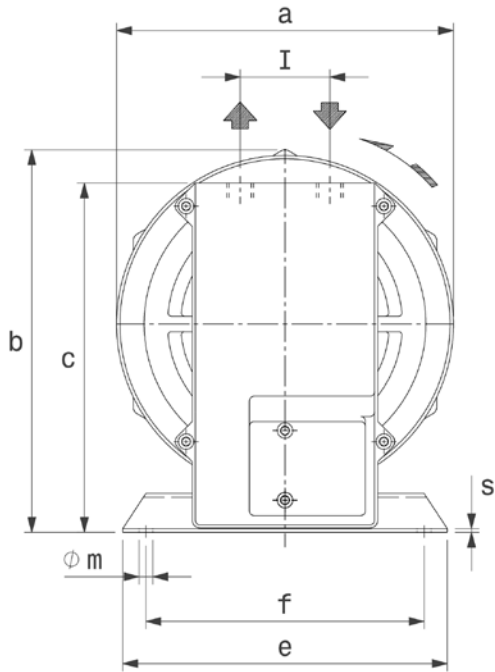

Dimensions in mm - FOR REFERENCE ONLY

Model	a	b	c	d	e	f	G
10DL-MD	220	256	230	23	210	180	G 1/2"
15DH-MD	250	286	258	30	210	180	G 3/4"

Model	H	i	m	n	o	r	s
10DL-MD	300	58	9	120	144	90	2,5
15DH-MD	335	64	9	120	144	120	2,5



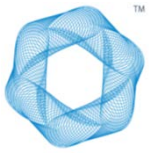

**FPZ**  
BLOWER TECHNOLOGY

**FPZ, Inc**

Saukville, Wisconsin  
USA  
usa@fpz.com

**FPZ Espana/Portugal**

Pral, Barcelona  
Espana  
mila.lozano@fpz.com

**FPZ France S.a.r.l.**

St. Priest  
France  
france@fpz.com

**HEADQUARTERS**

**FPZ S.p.A.**  
Concorezzo (MB)  
Italy  
info@fpz.com

**FPZ México/LA**

Zapopan, Jalisco  
México  
mexico@fpz.com

**FPZ UK**

Andover, Hampshire  
United Kingdom  
uk@fpz.com

**FPZ Austria & Germany**

Krems  
Austria  
vertrieb@fpz.com